



Bär Cargolift – Lifting Performance.



Innovation by Tradition – Bär Control EVO

Form follows function – it also controlled the Bär tail lift of the 80s according to this motto. Since then, the Bär control box has been a symbol for Bär Cargolift like no other component: Reduced to the essentials, with a focus on a logical process, tried and tested many times over in tough use.

Bär Cargolift now presents the next generation of its control box – affectionately referred to internally as “EVO”. Because the Bär Control EVO retains the proven, robust body as well as the **logical operating sequences**. New are the **outer shell** which is enhanced through the use of **aluminium** and the general compact design.

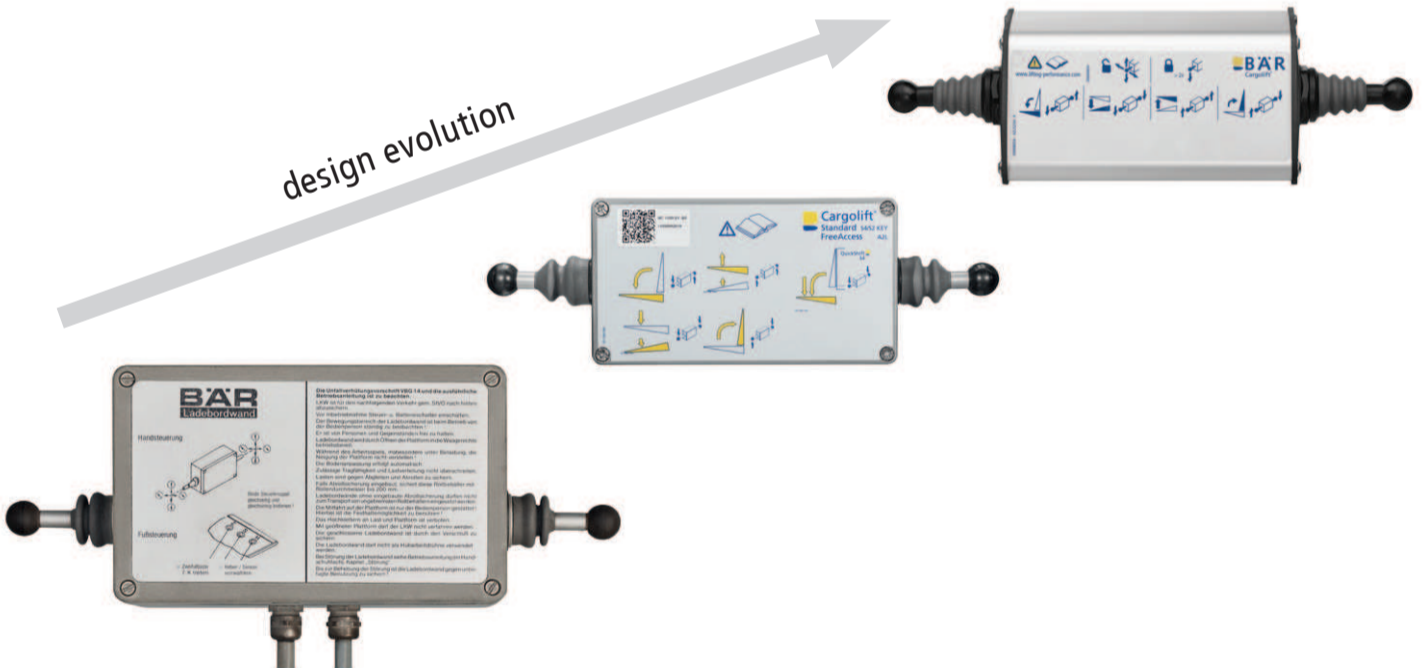

Also the technical evolution looks presentable: The robust **cross lever switches** with safety class IP 65 enables new functions like the innovative **SwitchKey**. In addition the modified data transfer from the lever switches to the eBC Controller facilitates a further reduction of electric components in the box – for an even higher availability of the Cargolifts.

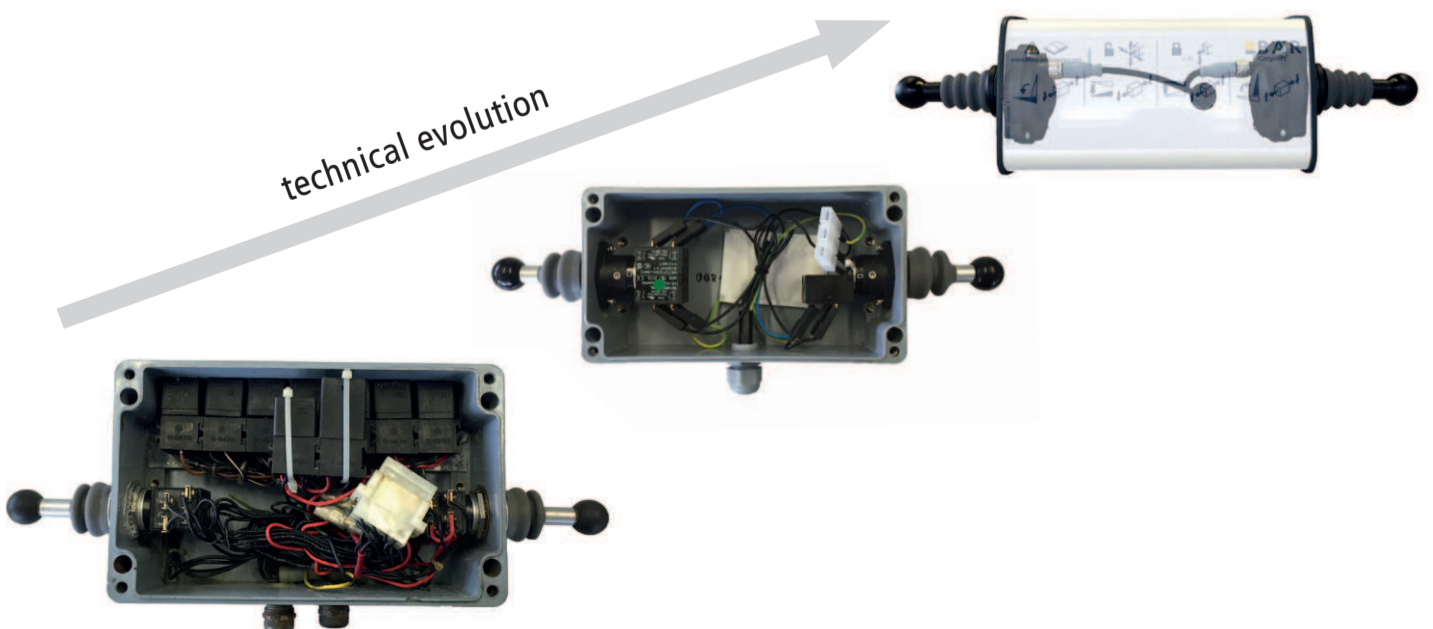

Cross lever switches

One cross lever switch – many possibilities. Because it can be fitted either on the left or the right hand side – no matter to which Cargolift type. At the same time it is more robust than ever with safety class IP 65 – not to mention new functions...

The right control lever with new features – as standard



Operating the right lever three times downward when the platform is open **switches off** the **flashing lights** e.g. at the ramp.



Operating it three times upward saves the **platform angle for tilting up** – a clear advantage for Standard S2 products.



The left control lever as the key – SwitchKey

In the daily rush you can easily forget to switch on the cabin control switch – or to switch off when leaving the working area. In both cases the optional SwitchKey may help. Because by a defined operating sequence of the left control lever the Cargolift may be switched on and off. More precisely: The control voltage is activated or deactivated. And the Cargolift is protected against unauthorized use directly in place.

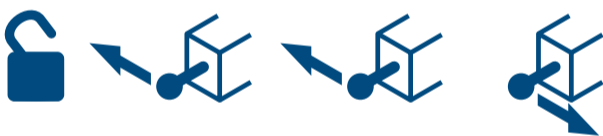

You will recognise a Cargolift with SwitchKey by the sticker on the Bär Control EVO as shown above. A customer-specific pre-fitted SwitchKey is possible. Ex works the SwitchKey operating sequence for activation is:

- To the vehicle
- To the vehicle
- To the user

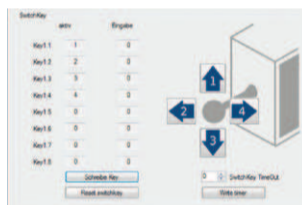

SwitchKey replaces the electric key switch. The operating sequence may be adapted by the diagnostic tool **Bär CargoCheck**.

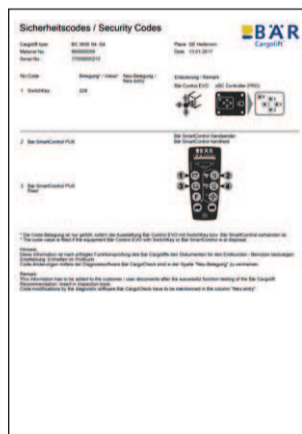

The active SwitchKey as well as its adaptation is documented by the opposite document in the inspection book.

Please note:
In case of emergency operation at the eBC Controller it might be necessary to switch on by the SwitchKey.

Fitment of Bär Control EVO and other components

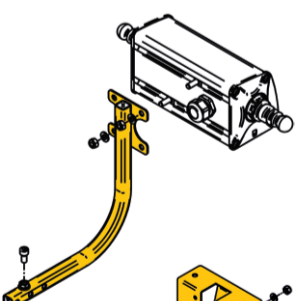

Fitment on underrun bar
Serial equipment for Standard S4 (except S4U) and Falt.

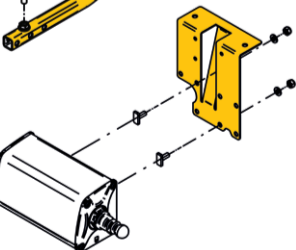

Fitment at vehicle body
Serial equipment for Standard S2 and S4U, option for Standard S4 and Falt.

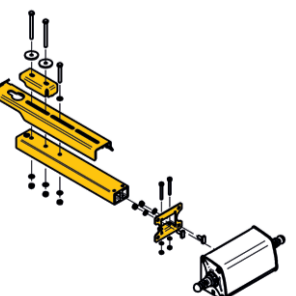

Fitment bracketed for semitrailer
Serial equipment for RetFalt (R2T/R4T), option for Standard S4.

Fitment bolted for truck
Serial equipment for RetFalt (R21/R41/R4C) and Ret/HydFalt.

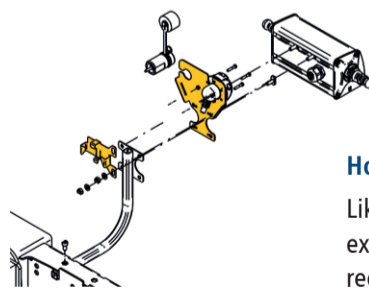

Holder for optional equipment
Like plug for cable remote control, external electric key switch or the receiver of Bär SmartControl delivered with the corresponding equipment.

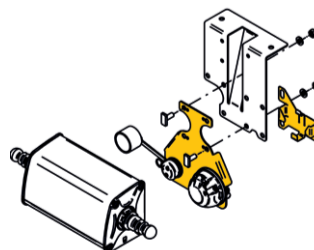

Protective cover
Option for Standard S2, S4 and Ret/HydFalt. Locking by padlock possible.